

InnoScreen™ COVID-19 Antigen Rapid Test Quick Guide (For Nasal Swab)

①

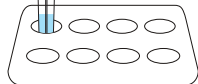

Insert the extraction tube into the tube stand. Unscrew the large cap of the extraction tube.



②

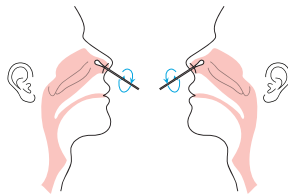

Insert the swab gently into nostril until you feel a slight resistance (about 1/2 to 3/4 inches up your nose). Roll the swab firmly around the inside of the nostril, making 5 complete circles. **Repeat this process for the other nostril to ensure that adequate specimen is collected from both nasal cavities. (use the same swab)**

③

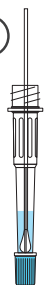

Insert the swab into the extraction tube.

④



Break off the swab handle at the breakpoint, discard the broken off handle.

⑨



Read results at 15 minutes.

15 minutes

⑤

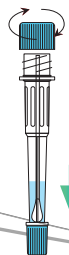

Replace the large cap onto the extraction tube. Make sure the cap is secure and tight.

⑥

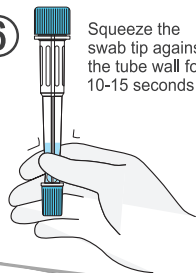

Squeeze the swab tip against the tube wall for 10-15 seconds.

⑦



Invert the tube, keep the small cap side up. Then unscrew the small cap.

⑧

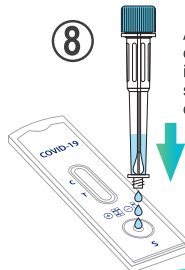

Add 3 drops of solution into the sample well of device.

⑩

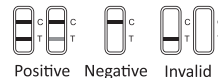

Positive Negative Invalid

InnoScreen™ COVID-19 Antigen Rapid Test Quick Guide (For NP/OP Swab)

1

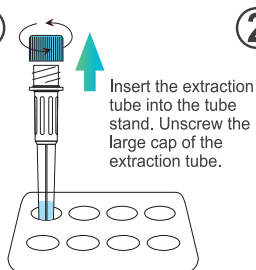

2



Insert the swab into the nostril parallel to the palate, and gently pushing the swab into the posterior nasopharynx. Slowly rotating against the nasal wall 5 times then remove it from the nostril.



Insert the swab from the mouth into the throat, centering on the red part of the throat wall and maxillary tonsils, rub the bilateral throat tonsils and throat wall moderately for 5 times. Avoid touching the tongue and remove the swab.

3

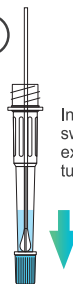

4

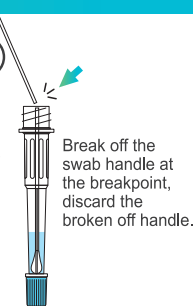

9



Read results at 15 minutes.

15 minutes

5

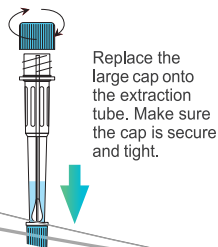

6

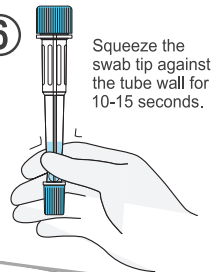

7

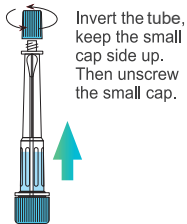

8

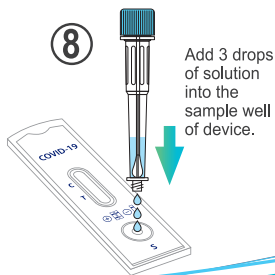

10

